

EFL 50 Furniture lock

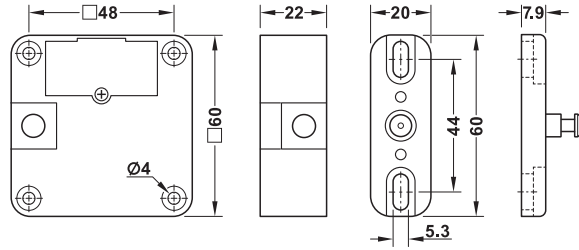

EFL 50 furniture lock

EFL50/EFL51 locking component

- > Area of application: Battery-operated, intelligent locker lock for indoor use: For wardrobes, lockers and compartment cabinets with doors made of wood or for sliding doors. Also suitable for glass doors.
- > Material: Plastic
- > Colour: Black

Supplied with

- 1 EFL50 furniture lock
- 1 set of installation instructions

Technical data

Technology	Mifare Classic EV1
Degree of protection	IP20
Battery	CR 123 3V
Battery service life	Approx. 20,000 locking and unlocking processes
Number of possible keys	49
Operating temperature	5 °C to +35 °C
Reading range	Card max. 20 mm; tag max. 10 mm

Functionality:

Standard mode

One or several (optional) user cards have a fixed allocation to one or several (optional) lockers for locking and unlocking. The lock remains open for 3 seconds after opening, and locks again automatically.

Wellness mode (free choice of locker)

Any user card can lock an open locker. When doing this, the user card is assigned to the selected locker, meaning that only this user card can unlock the locker again. When the locker is unlocked again, the assignment is erased.

Toggle mode (deadbolt lock function)

When an authorised transponder is held in front of the device, the lock unlocks and remains unlocked. When the authorised transponder is presented again, the lock is locked again.

Note

Particularly suitable for furniture constructions with soft closing and self closing mechanisms. For drawers and hinged doors with push-to-open function, the EFL50/EFL51 locking component with push-to-open function must also be installed.

If the battery voltage is too low, the lock no longer locks and a continuous tone lasting for 15 seconds is emitted.

In order to avoid interference between locks, a minimum distance of 10 cm must be maintained between installed locks and also during storage. If the distance is less than this minimum, continuous communication will take place between the locks, which will drain the battery.

In order to avoid unnecessary battery draining, do not insert the battery until start-up takes place.

EFL 50 furniture lock	Cat. No. 231.07.400
-----------------------	-------------------------------

Order reference

Please order the locking component and the batteries separately.

Modes which differ from the standard must be ordered separately (Wellness/Toggle programming cards).

Installation

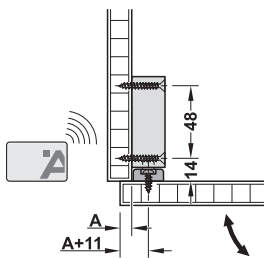

Hinged door installation

In order to unlock the EFL 50, the transponder card must be held against the side of the cabinet

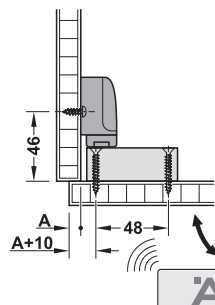

Hinged door with push-to-open function installation

In order to unlock the EFL 50, the transponder card must be held against the hinged door

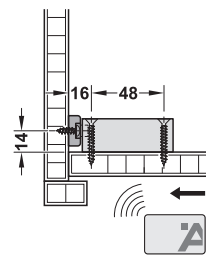

Sliding door installation

In order to unlock the EFL 50, the transponder card must be held against the sliding door

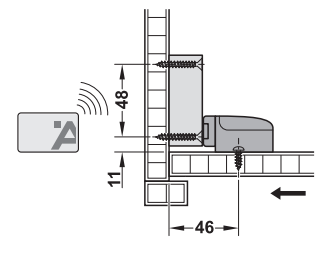

In order to unlock the EFL 50, the transponder card must be held against the side of the cabinet

DGH-M-INT 2020, HDE-en, 05/19; Dimensional data not binding. We reserve the right to alter specifications without notice.

→ EFL50/EFL51 Locking component

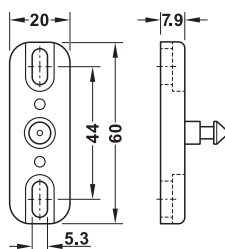

- > Area of application: For EFL 50 and EFL 51
- > Material: Plastic

The counterpiece has a predetermined breaking point which breaks at about 35 kg.

The locking bolt is floating, which can compensate for tolerances of +/- 3 mm.

Particularly suitable for furniture constructions with soft closing and self closing mechanisms.

Only EFL50/EFL51 locking component with Push-to-Open function is suitable for drawers and sliding doors with Push-to-Open function.

	Cat. No.
EFL50/EFL51 locking component	231.07.410

→ EFL50 Locking component with Push-to-Open function

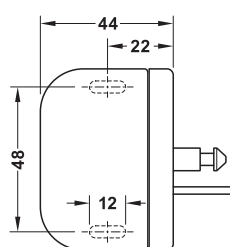

- > Area of application: For EFL 50
- > Material: Plastic
- > Version: With Push-to-Open function

The EFL50 locking component with Push-to-Open function combines 3-dimensional adjustment with an elegant design.

With a 90° installation facility, it is used on both hinged doors and drawers.

The integrated ejector (Push-to-Open function) with spring force of 5.4 N opens the door automatically as soon as the door is unlocked. Hinges with a hold-closed function are therefore not suitable for this combination.

The locking bolt is floating, which can compensate for tolerances of +/- 3 mm.

The integrated predetermined breaking point of 35 kg protects the furniture in the event of forced opening.

Not suitable for constructions with soft closing and self closing mechanisms.

	Cat. No.
EFL50 locking component with Push-to-Open function	231.07.411

→ EFL50/EFL51 Glass door set

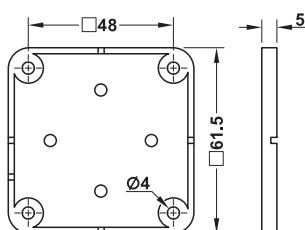
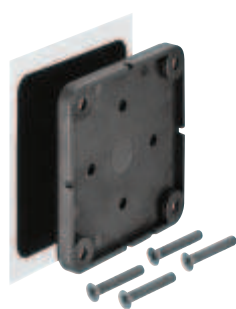

- > Area of application: For EFL 50 and EFL 51
- > Load bearing capacity: For hinged doors with up to 45 kg of pulling force, for sliding doors with up to 25 kg of shear force

	Cat. No.
EFL50/EFL51 glass door set	231.07.412

Supplied with

- 1 support plate with bonding surface
- 4 screws
- 1 black adhesive foil for opposite side

→ Battery



- > CR123 3V photo lithium battery

	Cat. No.
Battery	910.54.950

→ Programming cards

The purpose of the programming cards is either to assign user keys to the EFL 50 furniture locks, or switch between the different modes with which the EFL 50 can be operated: "Standard Mode", "Wellness Mode" and "Toggle Mode".

Programming card for EFL 50 "Standard Mode"

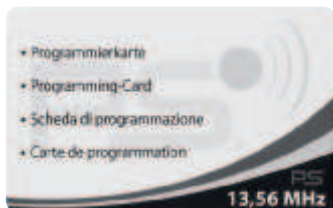

> Area of application: For teaching in user keys at the EFL 50 furniture lock or as a general key

In order to assign the programming card for EFL 50 "Standard Mode" to an EFL 50, the button on the back of the EFL 50 must be pressed and the programming card held in front of it within 3 seconds. The programming card can be assigned to 1 to n EFL 50 locks, but at least one programming card is required to be able to teach in the user keys. If an EFL 50 is assigned to a further programming card for EFL 50 "Standard Mode", the previously set value is overwritten, meaning that the programming card which was activated first loses its assignment to this EFL 50.

	Cat. No.
Programming card for EFL 50	231.07.423

"Wellness Mode" programming card

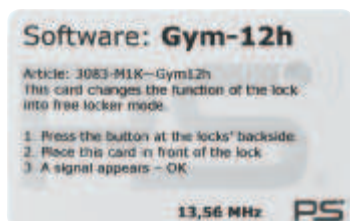

> Area of application: For the EFL 50 furniture lock for switching to "Wellness Mode"

In order to switch to "Wellness Mode" the button on the back of the EFL 50 must first be pressed, and the "Wellness Mode" programming card held in front of the device within 3 seconds. Successful programming is confirmed with 2 tones, and the EFL 50 furniture lock is now in "Wellness Mode". If an assigned user key is lost, the door can be opened using the programming card for EFL 50 "Standard Mode", whereby the assigned key loses its permissions for the associated EFL 50.

Note

The Gym-12h programming card / wellness mode can be used for opening the lock automatically after 24h, making sure that the cabinet does not remain closed, in the case that the user forgets to open the cabinet or takes the card away.

	Cat. No.
Wellness Mode programming card	231.07.420

"Toggle Mode" programming card

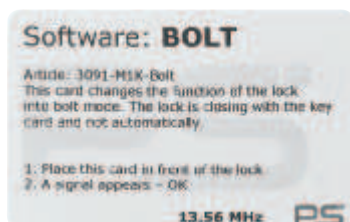

> Area of application: For the EFL 50 furniture lock for switching to "Toggle Mode"

In order to switch to "Toggle Mode", the "Toggle Mode" programming card must be held in front of the device. Successful programming is confirmed with 2 tones, and the EFL 50 furniture lock is now in "Toggle Mode".

	Cat. No.
Toggle Mode programming card	231.07.421

"Standard Mode" programming card



> Area of application: For the EFL 50 furniture lock for switching to "Standard Mode"

When it leaves the factory, the EFL 50 furniture lock is in "Standard Mode", but if this mode has been changed ("Wellness Mode" or "Toggle Mode"), the mode can be switched back to "Standard Mode" using this programming card.

In order to switch to "Standard Mode", the "Standard Mode" programming card must be held in front of the device. Successful programming is confirmed with 2 tones, and the EFL 50 furniture lock is now in "Standard Mode".

	Cat. No.
Standard Mode programming card	231.07.422

KT Key tag



- > Version: Waterproof
- > Material: Plastic

Functionality

- > Electronic keys for Dialock as key tag
- > 4 independent locking authorisations per key tag possible

Technical data

Data retention	≥10 years
Operating temperature	-35 °C to +50 °C
Transponder	Mifare Classic EV1 with 7 byte UID

	Technology	Colour	Cat. No.
	Mifare Classic EV1	Black	917.64.093
		Blue	917.64.098
		Red	917.64.099

KT Key tag



- > Functionality: Electronic keys for Dialock as key tag
- > Version: Solid, ultrasound welded and made waterproof
- > Material: Combination of stainless steel frame and impact resistant polycarbonate
- > Finish: Matt

Technical data

Data retention	≥10 years
Dimensions	Ø 36 mm, height: 5.3 mm
Operating temperature	-35 °C to +50 °C
Transponder	Mifare Classic EV1 with 7 byte UID

	Colour	Cat. No.
	White	917.64.147
	Black	917.64.143
	Green	917.64.145
	Red	917.64.149
	Blue	917.64.148
	Orange	917.64.141

Order reference



Text imprint or photo/graphic (template with min. 300 dpi required) on request.

KC key card

► FF 5.55

DGH-M-INT 2020, HDE-en, 05/19; Dimensional data not binding. We reserve the right to alter specifications without notice.